

BUILDER & DEVELOPERS:



Sumangalam Buildmart Pvt. Ltd.

CORPORATE OFFICE:

Sumangalam Buildmart Pvt. Ltd.

Plot No. 85-B Shrinathpuram Near BSNL Circle,
Kota(Raj.)-324010

email : info@sumangalambuildmart.com

web : www.shubhatlantis.com

web : www.sumangalambuildmart.com

For Booking Contact: 9649908036

ARCHITECT:



Mob. : +91 98281 37800

Web. : www.primeartarchitects.com
E-mail : primeartarchitects@gmail.com



FUSION FOR A HAPPY LIFE.



It's time to live in a place which defines your stature. After all, what marks your heritage is your grand home

STYLISH APARTMENTS
FOR SIGNATURE
LIFESTYLE !



**SHUBH
AFFINITY**
3BHK ULTIMATE LIVING





SHUBH
AFFINITY





THERE IS NO
BETTER PLACE
TO BE THAN
RIGHT HERE

The energy of the city. Stunningly spectacular view

Lavishly luxurious lifestyle, All this and much more. there is only

one place you can have it all. Welcome to Shubh Affinity





A HAVEN OF
TRANQUILLITY
AND
LUXURY

Welcome to Shubh Affinity....

because luxury living must offer Affinity joy to its residents!





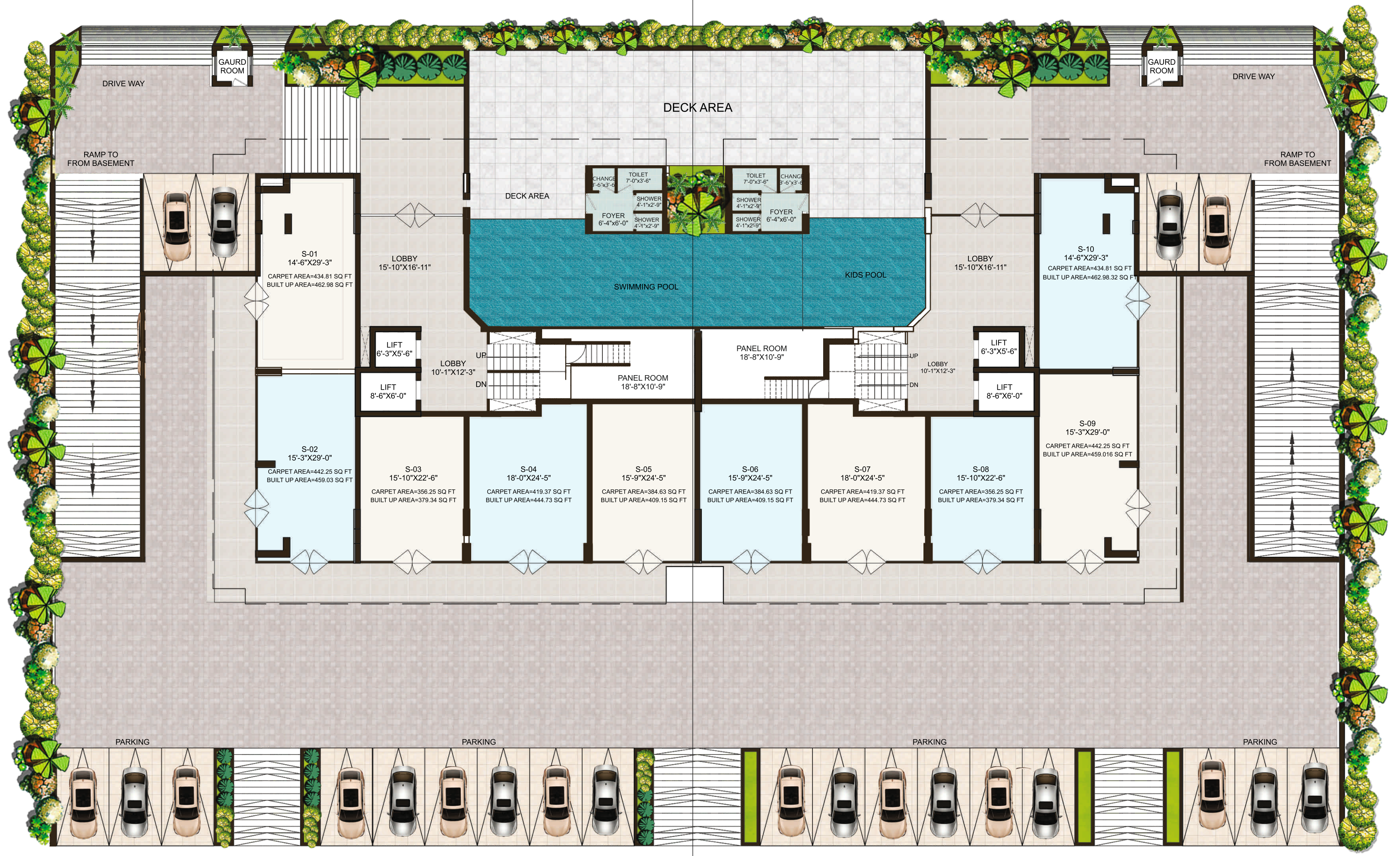
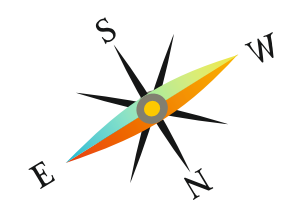

DRIVE WAY

GAURD ROOM

GAURD ROOM

DRIVE WAY

DECK AREA

RAMP TO FROM BASEMENT

RAMP TO FROM BASEMENT

S-01
14'-6"X29'-3"
CARPET AREA=434.81 SQ FT
BUILT UP AREA=462.98 SQ FT

LOBBY
15'-10"X16'-11"

S-10
14'-6"X29'-3"
CARPET AREA=434.81 SQ FT
BUILT UP AREA=462.98 SQ FT

LOBBY
15'-10"X16'-11"

LIFT
6'-3"X5'-6"

LOBBY
10'-1"X12'-3"

PANEL ROOM
18'-8"X10'-9"

LOBBY
10'-1"X12'-3"

LIFT
6'-3"X5'-6"

S-02
15'-3"X29'-0"
CARPET AREA=442.25 SQ FT
BUILT UP AREA=459.03 SQ FT

S-03
15'-10"X22'-6"
CARPET AREA=356.25 SQ FT
BUILT UP AREA=379.34 SQ FT

S-04
18'-0"X24'-5"
CARPET AREA=419.37 SQ FT
BUILT UP AREA=444.73 SQ FT

S-05
15'-9"X24'-5"
CARPET AREA=384.63 SQ FT
BUILT UP AREA=409.15 SQ FT

S-06
15'-9"X24'-5"
CARPET AREA=384.63 SQ FT
BUILT UP AREA=409.15 SQ FT

S-07
18'-0"X24'-5"
CARPET AREA=419.37 SQ FT
BUILT UP AREA=444.73 SQ FT

S-08
15'-10"X22'-6"
CARPET AREA=356.25 SQ FT
BUILT UP AREA=379.34 SQ FT

S-09
15'-3"X29'-0"
CARPET AREA=442.25 SQ FT
BUILT UP AREA=459.016 SQ FT

PARKING

PARKING

PARKING

PARKING

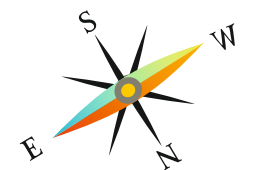

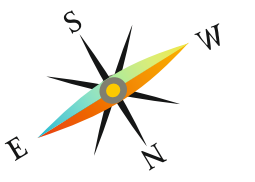

3BHK TYPE 01

Unit Floor plan

3BHK TYPE 01
 BUILT-UP AREA=1210.47 SQ. FT.
 SALABLE AREA=1729.24 SQ. FT.



ENTRY



ENTRY

3BHK TYPE 02

Unit Floor plan

3BHK TYPE 02
 BUILT-UP AREA=1114.10 SQ. FT.
 SALABLE AREA=1593.57 SQ. FT.



ENTRY



ENTRY

Project Highlights/Features :-



- ▲ A project by Sumangalam Group reputed and trusted group
- ▲ Designed only 3BHK Flats with Commercial Spaces
- ▲ Desined to exceed the expectation of these who Belive in a healthy and Happy Life Style
- ▲ Premium Construction Quality
- ▲ All Flats are on road facing
- ▲ Four Lifts and Two staircase for easy accessibility
- ▲ High tech & well equipped Clubhouse
- ▲ Vastu Oriented Apartments
- ▲ Functionally Designed with Pleasant Architecture
- ▲ 100% Power backup (Silent DG sets for lifts & common areas)
- ▲ High Tech Security Systems with C.C. TV
- ▲ 2 way video door phone in all flats
- ▲ 24 Hours water Supply
- ▲ Reserved car parking for each flat
- ▲ Efficient Fire Fighting and Rain water Harvesting system
- ▲ Earth Quake Resistant Framed Structure
- ▲ Separate washing area designed nearby kitchen in every apartment
- ▲ Store or Pooja room is given in Every Apartment
- ▲ A.C. copper live in every apartment

Amenities :-

- ▲ High tech & well equipped Clubhouse
- ▲ Air Conditioned Multipurpose Hall
- ▲ Well Equipped Gymnasium
- ▲ Indoor Games
- ▲ Chess, Card and Carom Room
- ▲ Pool Table and Table Tennis
- ▲ Guest Room
- ▲ Well Planned Covered & Open Parking Spaces for Residents & visitors
- ▲ Round the Clock Security by Modern Security Systems
- ▲ Mini Theater
- ▲ Swimming pool and Kids Pool
- ▲ 24 Hours water Supply

Specification :-



BEDROOMS

Floor	: Wooden Flooring in Master Bedroom Premium Class Flooring of Vitrified Tiles in Other Bedrooms
Walls	: Acrylic Plastic Paint on Putty (Asian/ Nerolac or Equivalent)
Ceiling	: Plastic Emulsion Paint on Ceiling
Wardrobes	: Projected Wardrobes Space
Door & Windows	: Wooden / UPVC Door Windows

KITCHEN

Counter	: Black / Grey Granite Working Counters
Fitting/ Fixtures	: CP Fittings With Stainless Steel Sink, Provision for RO/Aquaguard Electric Points for Microwave/Mixer, Refrigerators etc. 2' Tiles Dado Above the Counter Acrylic Emulsion Paint in Balance Area.
Floor	: Anti skid Tiles
Ceiling	: Plastic Emulsion Paint on Ceiling
Style	: Modular Kitchen With Chimney
Wash Area	: Separate Washing Area

BALCONIES

Floor	: Terazo/ Ceramic Tiles
Ceiling	: Plastic Emulsion Paint on Ceiling
Doors & Windows	: UPVC / Aluminum Door Windows.

LIVING/ DINING

Floor	: Vitrified Tiles Laid in Designer Pattern
Walls	: Acrylic Plastic Paint on Putty (Asian/ Nerolac or Equivalent)
Ceiling	: Plastic Emulsion Paint on Ceiling
Services	: Provision for Air Conditioners
Door & Windows	: Wooden / UPVC Door Windows

TOILET

Walls	: Combination of Designer Tile and Acrylic Emulsion Paint
Floor	: Anti Skid Ceramic Tiles.
Ceiling	: Plastic Emulsion Paint on Ceiling
Fixtures/ Assess	: C.P. Fitting Premium Brand or Equivalent
Doors	: Tough ISI Mark Flush Doors
Provisions	: Provision for Geyser and Exhaust Fan
Services	: Provision for Air Conditioners
Door & Windows	: Wooden / UPVC Door Windows

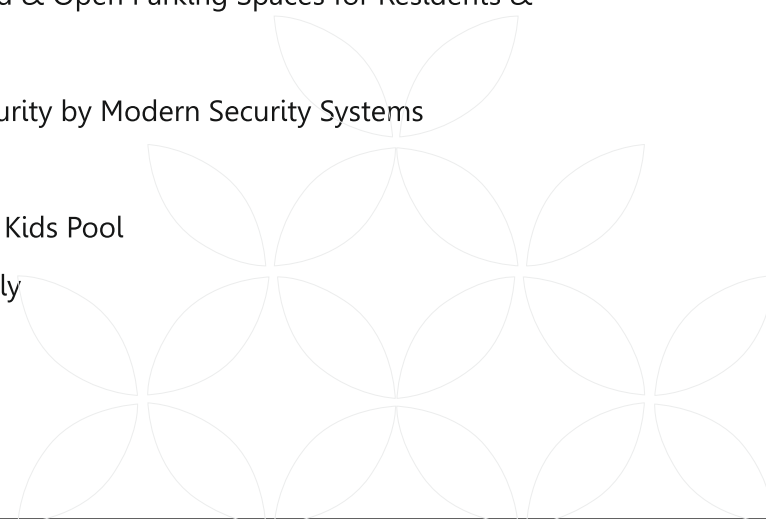



LOCATION MAP



Site Add.:- Plot No. CP-27 Vivekanad Nagar, Near Kalpana Chawla Circle, Kota (Raj.)-324005

Location Advantage:-

- ▲ Located on both side roads having 120 feet & 60 feet road
- ▲ Located at peaceful location of vivekanand Nagar, Near Kalpana Chawla Circle, Kota
- ▲ Walking distance 1/2 km from R.K.Puram Jain Temple & Balaji Dham Temple
- ▲ Approx 1km from Ahinsa Circle
- ▲ Approx 2.5 KM from Mahaveer Nagar Circle
- ▲ 1/2 KM from New Medical Hospital
- ▲ Proximity to Bansal Public School, Disha Delphi Public School & Other Reputed School

OUR PROJECTS



Disclaimer:
The Project Consultant has the rights to change the plans, design & specifications or revise the scheme as & when necessary as per by laws and designer's convenience.
This Brochure is not to be treated as part of the documents. It is only for easy display and information/ instruction regarding the Project.